

**EAST BUCHANAN COMMUNITY SCHOOL DISTRICT**  
**AGENDA - Special School Board Meeting**  
**May 31, 2023 at 5:00 p.m. in Library - Middle School Entrance**

1. **CALL TO ORDER/MISSION STATEMENT** - To challenge students to think critically, communicate effectively, develop values and contribute to society.

2. **APPROVE AGENDA**

*MOTION to approve the agenda*

1st: \_\_\_\_\_ 2nd: \_\_\_\_\_ Carried: Yes / No

3. **AGENDA**

a. Performance Coach on Supplemental Salary Schedule

*MOTION to approve placing the Performance Coach position on the Supplemental Salary Schedule in Column \_\_\_\_\_.*

1st: \_\_\_\_\_ 2nd: \_\_\_\_\_ Carried: Yes / No

b. FFA Advisor on Supplemental Salary Schedule

*MOTION to approve placing the FFA Advisor on the Supplemental Salary Schedule as 1% of base salary.*

1st: \_\_\_\_\_ 2nd: \_\_\_\_\_ Carried: Yes / No

c. Walk-in Cooler Purchase

*MOTION to approve the Walk-in Cooler Purchase as presented.*

1st: \_\_\_\_\_ 2nd: \_\_\_\_\_ Carried: Yes / No

4. **CLOSED SESSION** - To evaluate the professional competency of an individual whose appointment, hiring, performance, or discharge is being considered when a closed session is necessary to prevent needless and irreparable injury to that individual's reputation and that individual requests a closed session. Iowa Code 21.5(1)(i).

*MOTION to go into closed session per Iowa Code 21.5(1)(i).*

Time in: \_\_\_\_\_

1st: \_\_\_\_\_ 2nd: \_\_\_\_\_ Carried: Yes / No

Time out: \_\_\_\_\_

**5. EXEMPT SESSION** - To discuss strategy in matters relating to employment conditions of employees not covered by the collective bargaining law. Iowa Code 21.9.

*MOTION to go into exempt session per Iowa Code 21.9.*

*Time in:* \_\_\_\_\_

*1st:* \_\_\_\_\_ *2nd:* \_\_\_\_\_ *Carried: Yes / No*

*Time out:* \_\_\_\_\_

**6. FY24 NON-MASTER EMPLOYEE SALARY AND WAGE APPROVAL**

*MOTION to approve non-master employee salary and wage as discussed.*

*1st:* \_\_\_\_\_ *2nd:* \_\_\_\_\_ *Carried: Yes / No*

**7. ADJOURN**

*MOTION to adjourn the meeting.*

*1st:* \_\_\_\_\_ *2nd:* \_\_\_\_\_ *Carried: Yes / No*

**SUPPLEMENTAL SALARY SCHEDULE**

\$ 15.00	Pep Bus Sponsor (per event)
\$ 10.00	VCR Crew (one event/night)
\$ 18.00	VCR Crew (2 events/night)
\$ 200.00	Girls Basketball Chaperone
\$ 15.00	Elementary concert supervision (per concert)
\$ 15.00	Preschool PAC meetings (per meeting)
\$ 15.00	Preschool Spring Fling (per event)
\$ 35.00	Certified Staff Additional Pay (per hour)
\$ 24.00	MS/HS sub during prep period
\$ 16.00	Elementary sub during prep period

The following positions are to be paid at a percentage of the base salary as shown below:

Salary		Base	%
\$ 327.75	FBLA Sponsor	\$ 32,775	1%
\$ 327.75	Jr Class Sponsor	\$ 32,775	1%
\$ 327.75	Prom Sponsor	\$ 32,775	1%
\$ 327.75	Student Council Sponsor	\$ 32,775	1%
\$ 2,294.25	Secondary Vocal Music Concert	\$ 32,775	7%
\$ 1,311.00	Elementary Vocal Music Concert	\$ 32,775	4%

The following positions use the table shown below:

- Column 1 Buc Network - divided into 3 seasons (Fall - 40%, Winter - 40%, Spring - 20%)
- Column 1 MS Volleyball, MS Track, MS Wrestling, MS Baseball, MS Softball, School Play, Newspaper
- Column 2 MS Football, MS Basketball, Asst Volleyball, Asst Baseball, Asst Softball, Asst Track, Yearbook, Speech, Robotics
- Column 3 Asst Football, Asst Basketball, Asst Wrestling, Cheerleading, Dance Coach
- Column 4 Instrumental Music, Musical Director, HS Track, HS Golf, Cross Country (7-12)
- Column 5 HS Football, HS Basketball, HS Wrestling, HS Volleyball, HS Baseball, HS Softball
- Column 6 Athletic Director

\*Any HS sport that has 20+ athletes with no assistant coach will receive an additional \$600 to their contract.

\*Any MS sport that has 20+ athletes with no assistant coach will receive an additional \$500 to their contract.

\*A concert is a performance in school that is at least one hour in length. Contests shall not be included.

Base	\$ 32,775	Column 1		Column 2		Column 3		Column 4		Column 5		Column 6		Step
Step	Base	Factor	Amt	Factor	Amt	Factor	Amt	Factor	Amt	Factor	Amt	Factor	Amt	Step
1	\$ 32,775	5.00%	\$ 1,638.75	6.00%	\$ 1,966.50	8.00%	\$ 2,622.00	10.00%	\$ 3,277.50	12.00%	\$ 3,933.00	20.101%	\$ 6,587.94	1
2	\$ 32,775	5.50%	\$ 1,802.63	6.50%	\$ 2,130.38	8.50%	\$ 2,785.88	10.50%	\$ 3,441.38	12.50%	\$ 4,096.88	20.60%	\$ 6,751.81	2
3	\$ 32,775	6.00%	\$ 1,966.50	7.00%	\$ 2,294.25	9.00%	\$ 2,949.75	11.00%	\$ 3,605.25	13.00%	\$ 4,260.75	21.10%	\$ 6,915.69	3
4	\$ 32,775	6.50%	\$ 2,130.38	7.50%	\$ 2,458.13	9.50%	\$ 3,113.63	11.50%	\$ 3,769.13	13.50%	\$ 4,424.63	21.60%	\$ 7,079.56	4
5	\$ 32,775	7.00%	\$ 2,294.25	8.00%	\$ 2,622.00	10.00%	\$ 3,277.50	12.00%	\$ 3,933.00	14.00%	\$ 4,588.50	22.10%	\$ 7,243.44	5
6	\$ 32,775	7.00%	\$ 2,294.25	8.00%	\$ 2,622.00	10.50%	\$ 3,441.38	12.50%	\$ 4,096.88	14.50%	\$ 4,752.38	22.60%	\$ 7,407.31	6
7	\$ 32,775	7.00%	\$ 2,294.25	8.00%	\$ 2,622.00	11.00%	\$ 3,605.25	13.00%	\$ 4,260.75	15.00%	\$ 4,916.25	23.10%	\$ 7,571.19	7
8	\$ 32,775	7.00%	\$ 2,294.25	8.00%	\$ 2,622.00	11.00%	\$ 3,605.25	13.00%	\$ 4,260.75	15.50%	\$ 5,080.13	23.10%	\$ 7,571.19	8
9	\$ 32,775	7.00%	\$ 2,294.25	8.00%	\$ 2,622.00	11.00%	\$ 3,605.25	13.00%	\$ 4,260.75	16.00%	\$ 5,244.00	23.10%	\$ 7,571.19	9
10	\$ 32,775	7.00%	\$ 2,294.25	8.00%	\$ 2,622.00	11.00%	\$ 3,605.25	13.00%	\$ 4,260.75	16.50%	\$ 5,407.88	23.10%	\$ 7,571.19	10
11	\$ 32,775	7.00%	\$ 2,294.25	8.00%	\$ 2,622.00	11.00%	\$ 3,605.25	13.00%	\$ 4,260.75	16.50%	\$ 5,407.88	23.10%	\$ 7,571.19	11
12	\$ 32,775	7.00%	\$ 2,294.25	8.00%	\$ 2,622.00	11.00%	\$ 3,605.25	13.00%	\$ 4,260.75	16.50%	\$ 5,407.88	23.10%	\$ 7,571.19	12
13	\$ 32,775	7.00%	\$ 2,294.25	8.00%	\$ 2,622.00	11.00%	\$ 3,605.25	13.00%	\$ 4,260.75	16.50%	\$ 5,407.88	23.10%	\$ 7,571.19	13
14	\$ 32,775	7.00%	\$ 2,294.25	8.00%	\$ 2,622.00	11.00%	\$ 3,605.25	13.00%	\$ 4,260.75	16.50%	\$ 5,407.88	23.10%	\$ 7,571.19	14
15	\$ 32,775	7.00%	\$ 2,294.25	8.00%	\$ 2,622.00	11.00%	\$ 3,605.25	13.00%	\$ 4,260.75	16.50%	\$ 5,407.88	23.10%	\$ 7,571.19	15
16	\$ 32,775	7.00%	\$ 2,294.25	8.00%	\$ 2,622.00	11.00%	\$ 3,605.25	13.00%	\$ 4,260.75	16.50%	\$ 5,407.88	23.10%	\$ 7,571.19	16
17	\$ 32,775	7.00%	\$ 2,294.25	8.00%	\$ 2,622.00	11.00%	\$ 3,605.25	13.00%	\$ 4,260.75	16.50%	\$ 5,407.88	23.10%	\$ 7,571.19	17
18	\$ 32,775	7.00%	\$ 2,294.25	8.00%	\$ 2,622.00	11.00%	\$ 3,605.25	13.00%	\$ 4,260.75	16.50%	\$ 5,407.88	23.10%	\$ 7,571.19	18
19	\$ 32,775	7.00%	\$ 2,294.25	8.00%	\$ 2,622.00	11.00%	\$ 3,605.25	13.00%	\$ 4,260.75	16.50%	\$ 5,407.88	23.10%	\$ 7,571.19	19
20	\$ 32,775	7.00%	\$ 2,294.25	8.00%	\$ 2,622.00	11.00%	\$ 3,605.25	13.00%	\$ 4,260.75	16.50%	\$ 5,407.88	23.10%	\$ 7,571.19	20



# Quote

05/25/2023

**To:**

East Buchanan  
Dan Fox

**Project:**

EAST BUCHANAN - WALK IN  
414 5TH ST N.  
WINTHROP, IA 50682

**From:**

Rapids Wholesale  
Hunter Bell  
6201 South Gateway Dr  
Marion, IA 52302  
319-447-3504  
319-213-8661

Job Reference Number: 8693

\*\*\*\*\*Supply Chain Pricing Alert\*\*\*\*\*

Please note that as a result of current supply chain issues the pricing reflected on this quote is valid for ONLY 15 DAYS from Date on the quote  
Please Discuss any concerns with your Sales Representative

\*\*\*\*\*Supply Chain Pricing Alert\*\*\*\*\*

Item	Qty	Description	Sell	Sell Total
1	1 ea	WALK IN COOLER, MODULAR, REMOTE AmeriKooler Two Compartment Walk-in: 10 X 14 CLR . Actual Overall Dimension: 9'-9 3/4" x 13'-6" x 8'-2 1/4" (Rectangular)  Description:  Compartment 1 of 2 - Indoor Cooler, with Floor  Interior Dim:  9'-1 3/4" x 6'-3" x 7'-6 1/4" (w x l x h)  Temperature:  35°F  Insulation:  4" thick AK-XPS4 extruded foam with R-values of R-29 for coolers and R-32 for freezers with a 50 Year Thermal Warranty. UL Classified Core	\$33,953.76	\$33,953.76

Item	Qty	Description	Sell	Sell Total
------	-----	-------------	------	------------

Flame Spread 15, Smoke Rating less than 165.

Warranty:

15 Year Panel Warranty and 1 Year Parts Warranty

Finishes:

Interior walls: 26 Ga. Stucco Embossed Acrylume

Exterior walls: 26 Ga. Stucco Embossed Acrylume

Interior ceiling: 26 Ga. Stucco Embossed Acrylume

Exterior ceiling: 26 Ga. Stucco Embossed Acrylume

Floor Type:

Type 1L

Application: Pan Rolling Racks

NSF Floor panel rated for 850 LBS/ SQ. FT. Diamond tread plate .090"

Integral - Not Reinforced

Door:

(1) Standard 30" x 76" Left hinged flush door with brushed hardware.

Interior & Exterior finish: 26 Ga. Stucco Embossed Acrylume. Heavy

duty deadbolt handle latch. Digital LED Thermometer with pilot light

switch. 1807 11w, Vapor Proof, 120V. LED fixture. 82 Lumens /watt

Angled face . Requires 115vac. 1 amps.

Description:

Compartment 2 of 2 - Indoor Cooler, with Floor

Interior Dim:

9'-1 3/4" x 6'-3" x 7'-6 1/4" (w x l x h)

Temperature:

35°F

Insulation:

4" thick AK-XPS4 extruded foam with R-values of R-29 for coolers and

R-32 for freezers with a 50 Year Thermal Warranty. UL Classified Core

Flame Spread 15, Smoke Rating less than 165.

Item	Qty	Description	Sell	Sell Total
------	-----	-------------	------	------------

Warranty:

15 Year Panel Warranty and 1 Year Parts Warranty

Finishes:

Interior walls: 26 Ga. Stucco Embossed Acrylume  
 Exterior walls: 26 Ga. Stucco Embossed Acrylume  
 Interior ceiling: 26 Ga. Stucco Embossed Acrylume  
 Exterior ceiling: 26 Ga. Stucco Embossed Acrylume

Floor Type:

Type 1L  
 Application: Pan Rolling Racks  
 NSF Floor panel rated for 850 LBS/ SQ. FT.  
 Diamond tread plate .090" Integral - Not Reinforced

Door:

(1) Standard 30" x 76" Left hinged flush door with brushed hardware. Interior & Exterior finish: 26 Ga. Stucco Embossed Acrylume. Heavy duty deadbolt handle latch. Digital LED Thermometer with pilot light switch. 1807 11w, Vapor Proof, 120V. LED fixture. 82 Lumens /watt Angled face . Requires 115vac. 1 amps.

(1) 0.5 HP Bohn DOE Compliant Outdoor Condensing Unit, Model BCH0005MBACZA0000, 208-230/1/60, MCA 15 Amps, BTUH 7660, Medium Temperature, Scroll, Air-cooled, R-404A, This refrigeration system is designed and certified for use in walk-in cooler applications -

(1) Bohn DOE Compliant BEL0060AS6AMAB0400, 115/1/60, Low Profile Air Defrost, 0.9 Fan Amps with 2 Speed EC motor

(1) Extended 4 year compressor Warranty

(1) 0.5 HP Bohn DOE Compliant Outdoor Condensing Unit, Model BCH0005MBACZA0000, 208-230/1/60, MCA 15 Amps, BTUH 7660, Medium Temperature, Scroll, Air-cooled, R-404A, This refrigeration system is designed and certified for use in walk-in cooler applications -

(1) Bohn DOE Compliant BEL0060AS6AMAB0400, 115/1/60, Low Profile Air Defrost, 0.9 Fan Amps with 2 Speed EC motor

Item	Qty	Description	Sell	Sell Total
------	-----	-------------	------	------------

(1) Extended 4 year compressor Warranty

ITEM TOTAL: \$33,953.76

Cooler	2 ea	SHELVING UNIT, WITH METAL POST	\$400.49	\$800.98
--------	------	--------------------------------	----------	----------

1



**Fermod**  
 (6611/R1) Fermostock® Starter Shelving Unit, 4-tier, 71"H, 38"W x 18"D, 800 lbs. max weight per shelf, -40° to 140°F (-40° to 60°C) operating temperature range, adjustable composite feet, tool free assembly, removable polymer inserts (dishwasher safe to 212°F), 20 micron deep anodized aluminum, NSF (Made in France)

- 2 ea Lifetime warranty against rust & corrosion, standard
- 4 ea (6611/R1) Fermostock® Shelving Unit Expansion Kit, 4-tier, 71"H, 35"W x 18"D, 800 lbs. max weight per shelf, includes (1) upright, -40° to 140°F (-40° to 60°C) operating temperature range, adjustable composite feet, tool free assembly, removable polymer inserts (dishwasher safe to 212°F), 20 micron deep anodized aluminum, NSF (Made in France) \$311.65 \$1,246.60
- 4 ea Lifetime warranty against rust & corrosion, standard
- 4 ea (6611/R1) Fermostock® Shelf, horizontal, 47"W x 22"D, 800 lbs. max weight per shelf, -40° to 140°F (-40° to 60°C) operating temperature range, tool free assembly, removable vented polymer inserts (dishwasher safe to 212°F), 20 micron deep anodized aluminum, NSF (Made in France) \$85.43 \$341.72
- 4 ea Lifetime warranty against rust & corrosion, standard
- 8 ea (6611/R1) Fermostock® Angle Corner, anodized aluminum, for 22" deep \$13.14 \$105.12  
 Weight: 228.04 lbs total

ITEM TOTAL: \$2,494.42

Cooler	2 ea	SHELVING UNIT, WITH METAL POST	\$400.49	\$800.98
--------	------	--------------------------------	----------	----------

2



**Fermod**  
 (6611/R1) Fermostock® Starter Shelving Unit, 4-tier, 71"H, 38"W x 18"D, 800 lbs. max weight per shelf, -40° to 140°F (-40° to 60°C) operating temperature range, adjustable composite feet, tool free assembly, removable polymer inserts (dishwasher safe to 212°F), 20 micron deep anodized aluminum, NSF (Made in France)

- 2 ea Lifetime warranty against rust & corrosion, standard
- 4 ea (6611/R1) Fermostock® Shelving Unit Expansion Kit, 4-tier, 71"H, 35"W x 18"D, 800 lbs. max weight per shelf, includes (1) upright, -40° to 140°F (-40° to 60°C) operating temperature range, adjustable composite feet, tool free assembly, removable polymer inserts (dishwasher safe to 212°F), 20 micron deep anodized aluminum, NSF (Made in France) \$311.65 \$1,246.60
- 4 ea Lifetime warranty against rust & corrosion, standard
- 4 ea (6611/R1) Fermostock® Shelf, horizontal, 47"W x 22"D, 800 lbs. max weight per shelf, -40° to 140°F (-40° to 60°C) operating temperature range, tool free assembly, removable vented polymer inserts (dishwasher safe to 212°F), 20 micron deep anodized aluminum, NSF (Made in France) \$85.43 \$341.72

Item	Qty	Description	Sell	Sell Total
		safe to 212°F), 20 micron deep anodized aluminum, NSF (Made in France)		
4 ea		Lifetime warranty against rust & corrosion, standard		
8 ea		(6611/R1) Fermostock® Angle Corner, anodized aluminum, for 22" deep	\$13.14	\$105.12
		Weight: 228.04 lbs total		
			<b>ITEMTOTAL:</b>	<b>\$2,494.42</b>
2	1 ea	<b>INSTALL</b>	\$15,591.40	\$15,591.40
		Star Food Service Equipment & Repair		
		Includes:		
		Travel and Lodging for 2 nights		
		Demo of current box		
		Install of walk-in subfloor		
		Install of Walk-ins		
		Installation of Line-sets and the material for the lines up to 50' of run.		
		Evap placement must be determined prior to installation.		
		Start-up		
		Additional Notes		
		Plumbing and electrical by others		
		Inter-wiring between the evaps and condensers is by others.		
		Unforeseen issues outside Star's control will be billed to Rapids		
		Any roof penetrations is by others.		
			<b>ITEMTOTAL:</b>	<b>\$15,591.40</b>
			<b>Merchandise</b>	<b>\$54,534.00</b>
			<b>Freight</b>	<b>\$2,700.00</b>
			<b>Subtotal</b>	<b>\$57,234.00</b>
			<b>Total</b>	<b>\$57,234.00</b>



**Tax:** Unless otherwise indicated, sales prices do not include, and Purchaser is responsible for and agrees to pay (unless Purchaser shall provide Seller at the time an order is submitted with exemption certificate or other documents acceptable to taxing or custom authorities), all sales, use, value added, excise and all other federal, state or local or foreign taxes, import or customs fees and duties associated with an order, however designated, except for Seller's franchise taxes and taxes on Seller's net income. If applicable, a separate charge for taxes will be shown on Seller's invoice. Some taxes may not be known at the time of quotation. These taxes will be added to the final contract amount and Purchaser agrees to pay all such taxes.

**Freight:** Freight charges unless otherwise noted includes only delivery to dock or curbside, all unloading, set in place and leveling by customer. Lift gate delivery is available at an additional charge.

**Inspection of Freight:** To protect your investment, the bill of lading must only be signed after the merchandise is inspected. If this step is not taken and damage has occurred, there is no recourse with the freight company for resolution or reimbursement.

**Prices:** Prices are good for 30 days unless otherwise stated

**Returns:** No returns will be accepted without prior written authorization of the Seller. Returns are subject to a minimum 30% restocking charge. Purchaser shall be responsible for the cost of freight to return products. Notwithstanding the foregoing, no returns are permitted with respect to custom design and fabricated equipment and furniture.

**Specific Exclusions:** Unless otherwise stated the pricing on this contract is for equipment only and does not include freight, tax, delivery or set in place. In addition all electrical, mechanical, HVAC, plumbing materials and labor, and the fees permits and licenses associated with such work are excluded unless otherwise indicated. This exclusion includes but is not limited to the following: 1. Plumbing, gas piping, refrigeration drainline installation, hanging of hand sinks, all faucet and garbage disposal installation and setup, 2. Caulking of sinks, tables and other items, 3. Plumbing, electrical and other final connections, 4. Ductwork and all penetrations within building, and all balancing of exhaust hoods and makeup air, 5. Walkin cooler/freezer piping and penetrations, hanging of evaporator coils, condenser and compressor placement, defrost timer connection and all necessary heat tape, 6. Floor tile, grout, concrete, grout leveling, and concrete leveling. 7. Concrete curbs, concrete filler, and/or sand filler. 8. Supports/blocking for FS equipment. 9. Insulation, vapor barrier, and wear slabs at the freezers and coolers.

**Terms & Conditions:** Our standard terms require 100% payment in advance of merchandise shipping. If buyer chooses to use a credit card for payment 4% will be added to the sell price of the contract. Terms other than this will require credit applications and trade references, which may take up to 3 weeks to complete. Final contract will require signature and completion of our standard contract form which includes all terms and conditions as stated on the face page of the Seller's Conditional Sales Contract or AIA Contract documentation as appropriate.

**Acceptance:** \_\_\_\_\_ **Date:** \_\_\_\_\_

**Printed Name:** \_\_\_\_\_

**Project Grand Total: \$57,234.00**

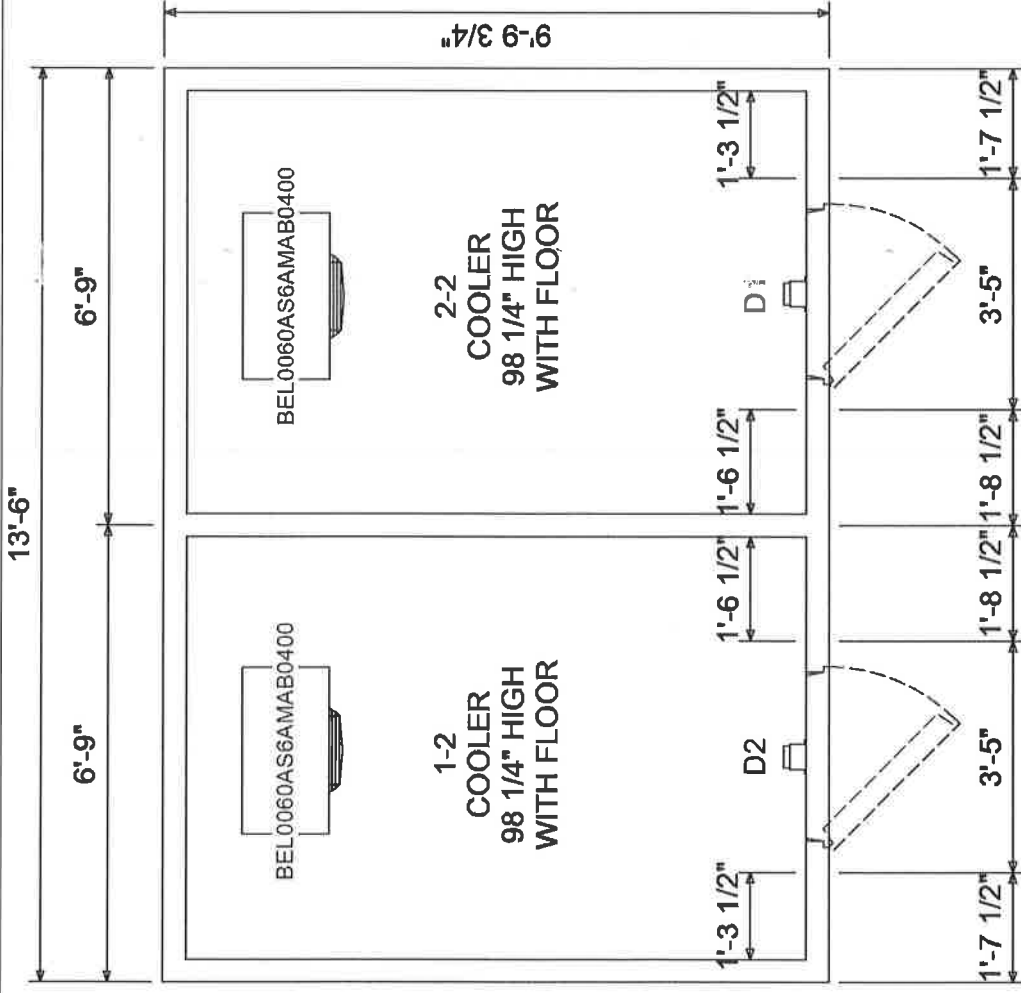

**-SPECIFICATION-**  
 Box Height: Cooler 8'-2 1/4" (7'-6 1/4" Interior)  
 Cooler 8'-2 1/4" (7'-6 1/4" Interior)  
 Insulation: 4" thick AK-XPS4 Extruded foam UL classified core flame spread 15. Smoke rating less than 165

**Compartment 1 - Cooler**  
 D2 - (1) Standard 30" x 76" Left hinged flush door with brushed hardware. Interior & Exterior finish: 26 Ga. Stucco Embossed Acrylume. Heavy duty deadbolt handle latch. Digital LED Thermometer with pilot light switch. 1807 11w, Vapor Proof, 120V. LED fixture. 82 Lumens /watt Angled face. Requires 115vac. 1 amps.

**Refrigeration:**  
 (1) 0.5 HP Bohn DOE Compliant Outdoor Condensing Unit, Model BCH0005MBAZ0000, 208-230/1/60, MCA 15 Amps. BTUH 7660. Medium Temperature. Scroll, Air-cooled, R-404A. This refrigeration system is designed and certified for use in walk-in cooler applications - Low Profile Air Defrost, 0.9 Fan Amps with 2 Speed EC motor

(1) Extended 4 year compressor Warranty

**Wall Panels**  
 Interior Finish: 26 Ga. Stucco Embossed Acrylume  
 Exterior Finish: 26 Ga. Stucco Embossed Acrylume

**Ceiling Panels**  
 Interior Finish: 26 Ga. Stucco Embossed Acrylume  
 Exterior Finish: 26 Ga. Stucco Embossed Acrylume

**Floor Panels**  
 NSF Floor panel rated for 850 LBS/ SQ. FT.  
 Diamond tread plate .090" Integral

**Application:** Pan Rolling Racks

**Compartment 2 - Cooler**  
 D1 - (1) Standard 30" x 76" Left hinged flush door with brushed hardware. Interior & Exterior finish: 26 Ga. Stucco Embossed Acrylume. Heavy duty deadbolt handle latch. Digital LED Thermometer with pilot light switch. 1807 11w, Vapor Proof, 120V. LED fixture. 82 Lumens /watt Angled face. Requires 115vac. 1 amps.

**Refrigeration:**  
 (1) 0.5 HP Bohn DOE Compliant Outdoor Condensing Unit, Model BCH0005MBAZ0000, 208-230/1/60, MCA 15 Amps. BTUH 7660. Medium Temperature. Scroll, Air-cooled, R-404A. This refrigeration system is designed and certified for use in walk-in cooler applications - Low Profile Air Defrost, 0.9 Fan Amps with 2 Speed EC motor

(1) Extended 4 year compressor Warranty

Customer Approval:

Quote #: 23-13562 Revision: 2

Project: East Buchannan School Walk-In

Date: 05/19/2023

Customer: Rapids Foodservice Contract and Design (XYZ Group)

Page 1 of 3



**-SPECIFICATION-Continued**

**Wall Panels**

- Interior Finish: 26 Ga. Stucco Embossed Acrylume
- Exterior Finish: 26 Ga. Stucco Embossed Acrylume
- Cailling Panels
- Interior Finish: 26 Ga. Stucco Embossed Acrylume
- Exterior Finish: 26 Ga. Stucco Embossed Acrylume
- Floor Panels

NSF Floor panel rated for 850 LBS/ SQ. FT.

Diamond tread plate .090" Integral

Applications: Pan Roasting Racks

Accessories Shipped Loose:

**Notes:**

- \* Allow a minimum of 2" clearance around all sides of the walk-in for proper air circulation

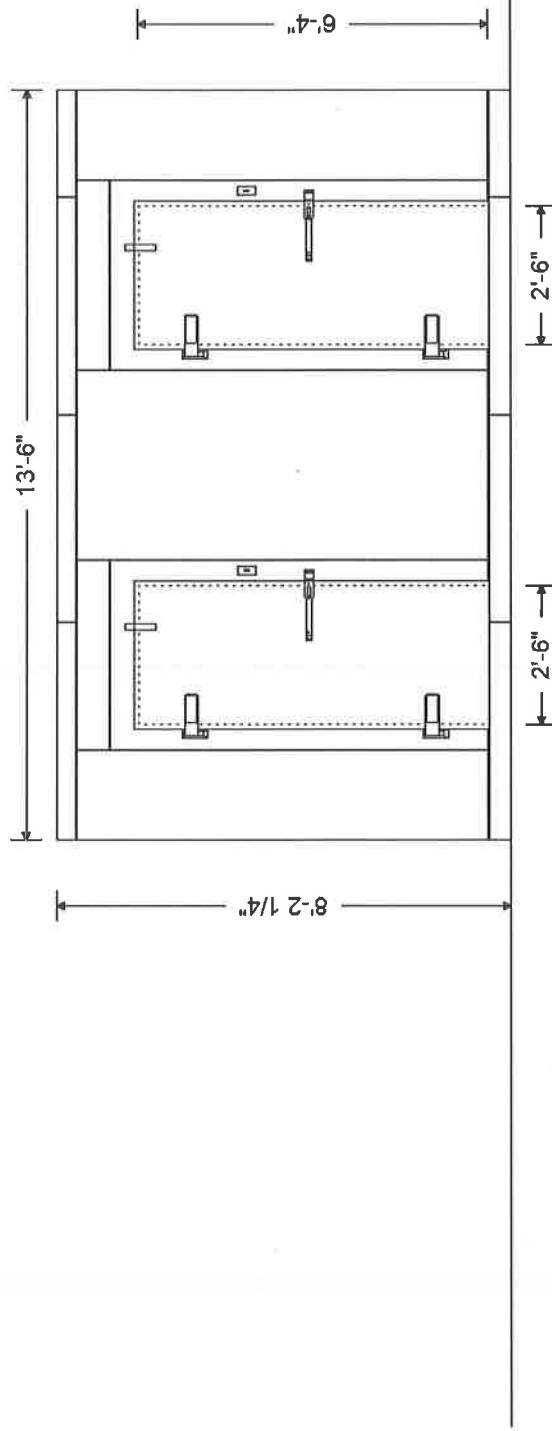

Customer Approval:

Quote #: 23-13562 Revision: 2

Project: East Buchanan School Walk-In

Date: 05/19/2023

Customer: Rapids Foodservice Contract and Design (XYZ Group)

Page 2 of 3



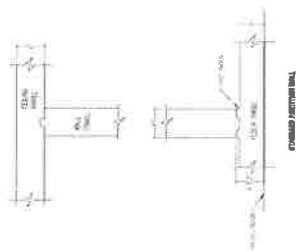
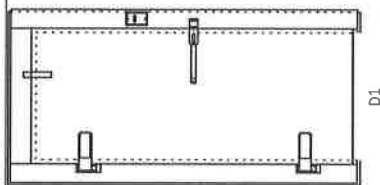
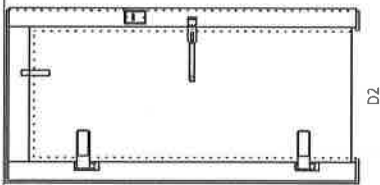

NOTE: SEE ALL NOTES ON SHEET 001 AND 002 FOR ALL DIMENSIONS AND TOLERANCES.

Quote #: 23-13562 Revision: 2

Project: East Buchanan School Walk-In

Date: 05/19/2023

Customer: Rapias Foodservice Contract and Design (XYZ Group)

Page 3 of 3



**FERMOD®**

Item # \_\_\_\_\_

Job \_\_\_\_\_

**FERMOD®**

was the very first company in the world to create and produce the concept of aluminum shelving and is the number one brand of food-grade shelving in Europe.

The shelving is of extruded and anodized aluminum construction with polymer inserts. The uprights are pre-assembled at the factory and the side rails ship with the polymer inserts. Assembly is via machined aluminum conical clamps that snap into pre-drilled holes in the uprights. The product is very easy to clean, very light, simple to assemble (no tools required), and comes with a **lifetime warranty against rust and corrosion**. We offer starter and expansion units as well as very comprehensive room configurations with open corners for all your shelving needs which also include mobile shelving, dunnage, and keg racks. We also have a unique capability in the industry to fully customize multiple rooms while fully communicating the layout specifications to the customer – thus creating MUCH less work on the part of the assembly team.



- High rigidity and stability due to (patented) assembly with conical anodized aluminium clips.
- Corner configuration available with full-depth connection and complete unobstructed access with the possibility of combining two different depths of shelving at the corners
- Uprights delivered fully assembled from the factory
- Tool-less quick and easy assembly with adjustable feet
- Incremental height adjustment in 6 in. (150mm) increments without the use of any tools
- Easy cleaning via the use of removable (and dish-washable) shelf inserts (machine washable up to 100°C)
- Maximum weight/level : 800 lbs. per shelf over an evenly distributed load (600 lbs. per shelf for shelves longer than 47")
- Maximum weigh/unit: 2000 lbs. between two uprights, and 1300 lbs. between two uprights with angle configuration.
- NSF Certified
- Product is packaged in pre-perforated shrink-wrapped plastic, requiring only a finger to open!
- Three depths (14", 18", and 22"), three heights (66", 71", and 83") and ten lengths available
- We have a unique capability to fully customize multiple rooms while communicating the layout specifications to the customer – thus creating MUCH less work on the part of the assembly team.
- Fermod shelving will not corrode or rust! No more complaints from health inspectors! We offer a **lifetime warranty against rust and corrosion!**

**FERMOD® 6611/R Modular Shelving System with Removable Shelf Inserts**

Fermod, Inc.  
500 Lake Cook Rd.  
Suite 350  
Deerfield, IL 60015

Toll-Free : 888-484-0367  
Office : 847-231-0367  
Fax : 847-231-0366  
Website : [www.fermod.com](http://www.fermod.com)  
Email : [uscontact@fermod.com](mailto:uscontact@fermod.com)

Printed in U.S.A.

10/17

Information and specifications are subject to change without notice.

Copyright © 2017 Fermod, Inc.

Job \_\_\_\_\_

**6611/R Modular Shelving System with Removable S Inserts**

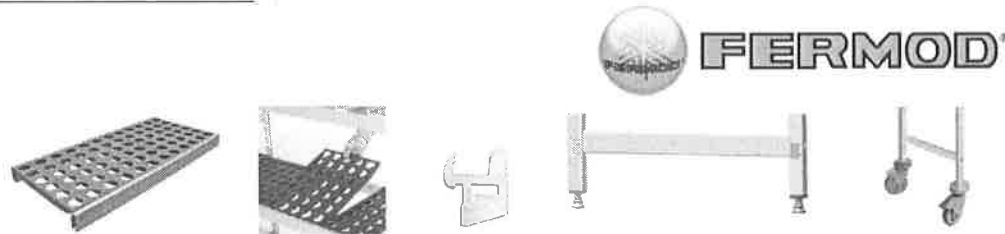

**Material Specifications:**

- Shelving uprights and cross-rails: Extruded, anodized aluminum with a 20 micron anodization
- Shelf Mats: Robust and resistant food-grade polymer
- Connector clips: Machined aluminum
- Temperature range: -40°C to 60°C (-40°F to 140°F) with intermittent exposure to 100°C (212°F) for cleaning.

**STARTER KITS**

Shelf Width / Length (in.)	Shelf Width / Length (mm)	66" Uprights	71" Uprights	83" Uprights	71" Mobile Uprights	Approx Unit Weight (lbs.)
14x26	360x660	4R26A66	4R26A71	4R26A83	4R26A71M	25.6
14x31	360x780	4R31A66	4R31A71	4R31A83	4R31A71M	28.5
14x35	360x900	4R35A66	4R35A71	4R35A83	4R35A71M	31.4
14x38	360x960	4R38A66	4R38A71	4R38A83	4R38A71M	33.1
14x42	360x1080	4R42A66	4R42A71	4R42A83	4R42A71M	35.1
14x47	360x1200	4R47A66	4R47A71	4R47A83	4R47A71M	38.1
14x52	360x1320	4R52A66	4R52A71	4R52A83	4R52A71M	40.6
14x59	360x1500	4R59A66	4R59A71	4R59A83	4R59A71M	43.9
14x64	360x1620	4R64A66	4R64A71	4R64A83	4R64A71M	48.1
14x68	360x1720	4R68A66	4R68A71	4R68A83	4R68A71M	51.8
18x26	460x660	4R26B66	4R26B71	4R26B83	4R26B71M	29.9
18x31	460x780	4R31B66	4R31B71	4R31B83	4R31B71M	32.9
18x35	460x900	4R35B66	4R35B71	4R35B83	4R35B71M	36.2
18x38	460x960	4R38B66	4R38B71	4R38B83	4R38B71M	37.4
18x42	460x1080	4R42B66	4R42B71	4R42B83	4R42B71M	40.4
18x47	460x1200	4R47B66	4R47B71	4R47B83	4R47B71M	44.1
18x52	460x1320	4R52B66	4R52B71	4R52B83	4R52B71M	47.5
18x59	460x1500	4R59B66	4R59B71	4R59B83	4R59B71M	51.6
18x64	460x1620	4R64B66	4R64B71	4R64B83	4R64B71M	55.4
18x68	460x1720	4R68B66	4R68B71	4R68B83	4R68B71M	60.8
22x26	560x660	4R26C66	4R26C71	4R26C83	4R26C71M	33.5
22x31	560x780	4R31C66	4R31C71	4R31C83	4R31C71M	36.8
22x35	560x900	4R35C66	4R35C71	4R35C83	4R35C71M	40.6
22x38	560x960	4R38C66	4R38C71	4R38C83	4R38C71M	42.7
22x42	560x1080	4R42C66	4R42C71	4R42C83	4R42C71M	46.4
22x47	560x1200	4R47C66	4R47C71	4R47C83	4R47C71M	49.3
22x52	560x1320	4R52C66	4R52C71	4R52C83	4R52C71M	53.5
22x59	560x1500	4R59C66	4R59C71	4R59C83	4R59C71M	59.3
22x64	560x1620	4R64C66	4R64C71	4R64C83	4R64C71M	63.9
22x68	560x1720	4R68C66	4R68C71	4R68C83	4R68C71M	68.5

**Part Number Logic for Starter and Expansion Units:**

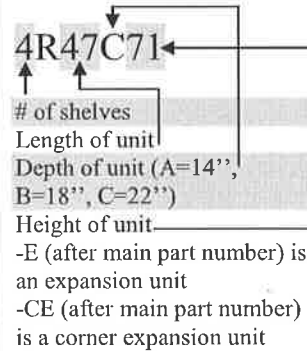

**ACCESSORIES**

Description	Part No.	Approx Unit Weight (lbs.)
Label Holder	61868	0.2
Wall Bracket	1718000	0.2
Aluminum Clips-pk of 4	61866	0.2

\* Starter Units consist of two uprights and four shelves  
 \*\* Expansion Units are available (1upright and 4 shelves) by adding a -E to the parent sku  
 \*\*\* Corner Expansion Units are available (1upright, 4 shelves, and 4 corners) by adding a -CE to the parent sku  
 \*\*\*\* Dimensions in inches have been rounded to the nearest inch

**UPRIGHTS**

66" Uprights	71" Uprights	83" Uprights	Mobile Uprights	Width (in.)	Width (mm)	Approx Unit Weight (lbs.)
6425311	642531180	642531120	64314	14	360	5.6
6425411	642541180	642541120	64315	18	460	6.2
6425511	642551180	642551120	64316	22	560	6.6

\* Two uprights are required for a full starter unit, one upright for any expansion unit

**ANGLE CORNERS**

14" Length	18" Length	22" Length	Approx Unit Weight (lbs.)
64234	64235	64236	0.5

Fermod anodized aluminum construction shelving with removable and dishwasher safe polymer inserts. 800 lbs. maximum weight per shelf with operating temperatures between -40° F to 140° F (-40° C to 60° C). Completely tool-free assembly. 20 Micron-deep anodized aluminum construction with machined aluminum shelf clips. Polymer & stainless steel rustproof casters, NSF. Standard Lifetime Warranty against rust and corrosion. Made in France

Fermod, Inc.  
 500 Lake Cook Rd.  
 Suite 350  
 Deerfield, IL 60015

Toll-Free : 888-484-0367  
 Office : 847-231-0367  
 Fax : 847-231-0366  
 Website : [www.fermod.com](http://www.fermod.com)  
 Email : [uscontact@fermod.com](mailto:uscontact@fermod.com)

Printed in U.S.A. 10/17

Information and specifications are subject to change without notice.

Copyright © 2017 Fermod, Inc.